

OPERATING MANUAL

ROOM AIR CONDITIONER SPLIT TYPE

Indoor Unit

ASY17AS

ASY17RS

Outdoor Unit

AOY17AN

AOY17RN

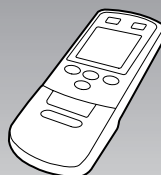
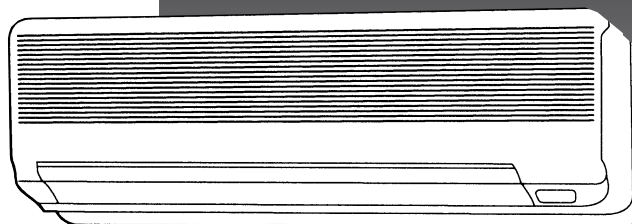

English



KEEP THIS OPERATION MANUAL
FOR FUTURE REFERENCE

CONTENTS

SAFETY PRECAUTIONS	1	SLEEP TIMER OPERATION	12
NAME AND FUNCTION OF PARTS	2	CARE AND MAINTENANCE	13
PREPARATION	4	TROUBLE SHOOTING	15
OPERATION	6	OPERATION DETAILS	16
AIR DIRECTION ADJUSTMENT	9	SPECIFICATIONS	18
TIMER OPERATION	11		

SAFETY PRECAUTIONS

- Before using the appliance, read these "PRECAUTIONS" thoroughly and operate in the correct way.
- The instructions in this section all relate to safety; be sure to maintain safe operating conditions.
- "DANGER", "WARNING" and "CAUTION" have the following meanings in these instructions:

 DANGER!	This mark indicates procedures which, if improperly performed, are most likely to result in the death of or serious injury to the user or service personnel.
 WARNING!	This mark indicates procedures which, if improperly performed, might lead to the death or serious injury of the user.
 CAUTION!	This mark indicates procedures which, if improperly performed, might possibly result in personal harm to the user, or damage to property.

DANGER!

- Do not attempt to install this air conditioner by yourself.
- This unit contains no user-serviceable parts. Always consult authorized service personnel for repairs.
- When moving, consult authorized service personnel for disconnection and installation of the unit.
- Do not become over-exposed to cold air by staying in the direct path of the air flow of the air conditioner for extended periods of time.
- Do not insert fingers or objects into the outlet port or intake grilles.
- Do not start and stop air conditioner operation by turning off the electrical breaker or disconnecting the power supply plug and so on.
- Take care not to damage the power supply cord.
- In the event of a malfunction (burning smell, etc.), immediately stop operation, turn off the electrical breaker or disconnect the power supply plug, and consult authorized service personnel.

CAUTION!

- Provide occasional ventilation during use.
- Do not direct air flow at fireplaces or heating apparatus.
- Do not climb on, or place objects on, the air conditioner.
- Do not hang objects from the indoor unit.
- Do not set flower vases or water containers on top of air conditioners.
- Do not expose the air conditioner directly to water.
- Do not operate the air conditioner with wet hands.
- Do not pull power supply cord.
- Turn off power source when not using the unit for extended periods.
- Always turn off the electrical breaker or disconnect the power supply plug whenever cleaning the air conditioner or the air filter.
- Connection valves become hot during Heating; handle with care.
- Check the condition of the installation stand for damage.
- Do not place animals or plants in the direct path of the air flow.
- Do not drink the water drained from the air conditioner.
- Do not use in applications involving the storage of foods, plants or animals, precision equipment, or art works.
- Do not apply any heavy pressure to radiator fins.
- Operate only with air filters installed.
- Do not block or cover the intake grille and outlet port.
- Ensure that any electronic equipment is at least one metre away from either the indoor or outdoor units.
- Avoid installing the air conditioner near a fireplace or other heating apparatus.
- When installing the indoor and outdoor unit, take precautions to prevent access to infants.
- Do not use inflammable gases near the air conditioner.

NAME AND FUNCTION OF PARTS

Instructions relating to heating (*) are applicable only to "HEAT & COOL MODEL" (Reverse Cycle).
 For details of operation, see the pages indicated by the (E35) mark.

Fig. 1

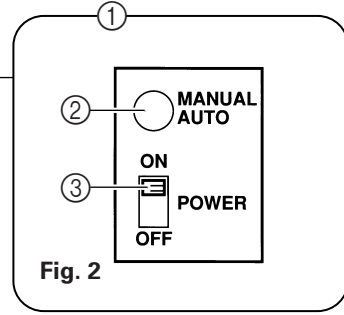
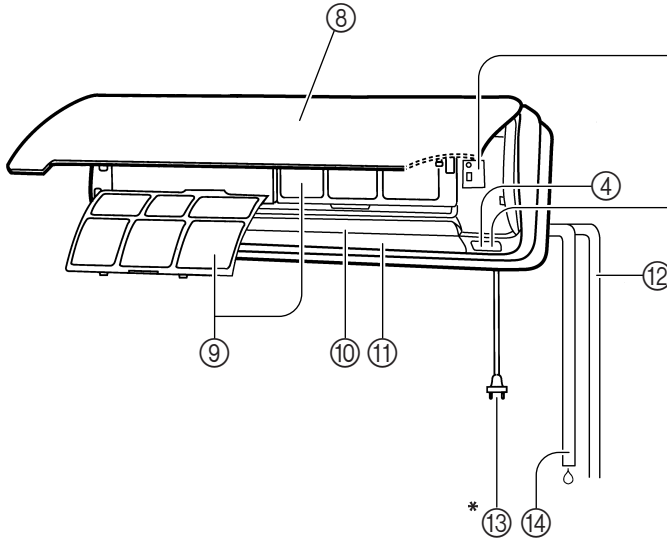

Fig. 2

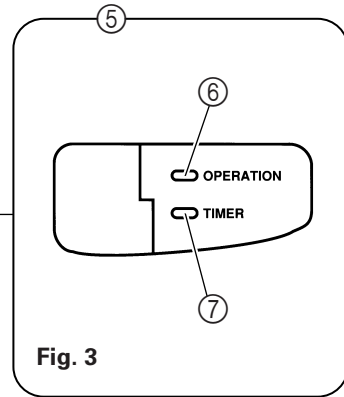

Fig. 3

Fig. 4

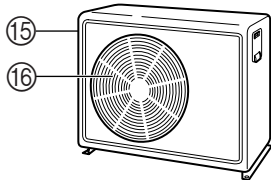

Fig. 5

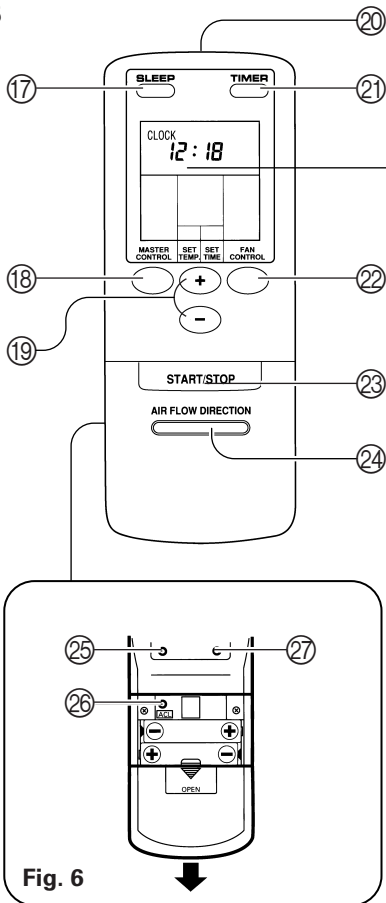

Fig. 6

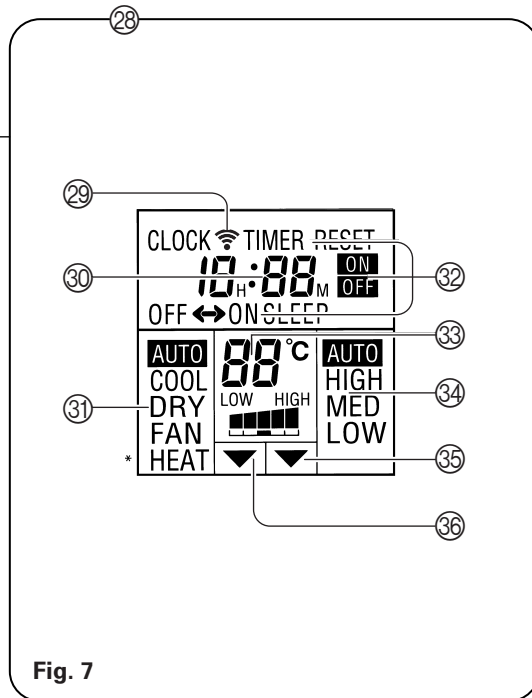

Fig. 7

Fig. 1 Indoor Unit

- ① **Operating Control Panel (Fig. 2)**
- ② **MANUAL AUTO button**

This button can be used for temporary operation in the AUTOMATIC mode in the event the remote control unit is unavailable.

Press the MANUAL AUTO button

 - Fan speed will be set to "AUTO" and the thermostat will be set for "normal".
 - To stop operation, either press the MANUAL AUTO button once again, or set the POWER switch to OFF.
- ③ **POWER switch**

ON : Set to this position when using the unit.
OFF : Set to this position when not using the unit for an extended period of time.
- ④ **Remote Control Signal Receiver (P. 5)**

Signals from the remote control unit are received here.
- ⑤ **Indicator Lamps (Fig. 3)**

These indicator lamps show the current operating status.
- ⑥ **OPERATION Indicator (red)**
 - Lights when unit is operating.
 - Flashes quickly for about one second when a signal is received from the remote control unit.
 - * ● Flashes slowly during defrosting operation. (P. 17)
- ⑦ **TIMER Indicator (green)**

Lights during TIMER operation.
- ⑧ **Air Intake Grille**

Air is taken in here.
- ⑨ **Air Filter (P. 14)**

Removes all dirt and dust from the air.
- ⑩ **Air flow-direction Louvers (P. 9)**

Control airflow in the vertical (up-down) direction.
- ⑪ **Right-left Louvers (P. 10)**

(behind Air flow-direction Louvers)

Control airflow in the horizontal (right-left) direction.
- ⑫ **Pipe Unit**
- * ⑬ **Power Plug**
- ⑭ **Drain Hose**

Moisture condensed from the air during Cooling and Drying operations is drained here.

Fig. 4 Outdoor Unit

- ⑮ **Air inlet**

(Rear and side panels)
- ⑯ **Air outlet**

Warm or cool air is blown out.

Fig. 5 Remote Control Unit

- ⑰ **SLEEP Button (P. 12)**
 - ⑱ **MASTER CONTROL Button**
 - ⑲ **SET TEMP./SET TIME Buttons (+/-)**
 - ⑳ **Signal Transmitter**
 - ㉑ **TIMER Button (P. 11 and 12)**
 - ㉒ **FAN CONTROL Button**
 - ㉓ **START/STOP Button**
 - ㉔ **AIR FLOW DIRECTION Button (P. 9)**
- Rear side (Fig. 6)**
- ㉕ **TIME ADJUST Button (P. 5)**
 - ㉖ **ACL Button (P. 4)**

(located inside battery compartment)

This button is used when replacing batteries.
 - ㉗ **TEST RUN Button**

This button is used when testing the air conditioner after installation. Do not use under normal conditions.
- Remote Control Unit Display (Fig. 7)**
- ㉘ **Transmit Indicator**
 - ㉙ **Clock Display**
 - When CLOCK is displayed, the current time is shown in 24-hour format (0:00 to 23:59).
 - When TIMER is displayed, the timer setting is shown in 24-hour format (0:00 to 23:59).
 - When SLEEP timer has been selected, the display shows the remaining time until the unit turns off (0H:05M to 9H:55M).
 - ㉚ **Operating Mode Display**
 - ㉛ **Timer Mode Display**
 - ㉜ **Fan Speed Display**
 - ㉝ **Temperature Set Display**
 - ㉞ **Timer Set Indicator**
 - ㉟ **Temperature Set Indicator**

PREPARATION

Turn on the Power

- 1 Connect the power plug to an electrical point.
- 2 Open the Intake Grille.
- 3 Set the POWER switch to ON (Fig. 2 ③).
- 4 Close the Intake Grille.

Opening/closing the Intake Grille

- ① Press both lower sides of the intake grille until you hear a clicking sound.
- ② Release your hands and the intake grille will open toward the front.

Do not operate the unit with the intake grille open, since malfunctions may result.

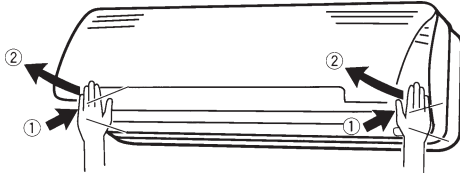

Press the both lower sides of the intake grille until you hear a clicking sound and the grille locks into place.

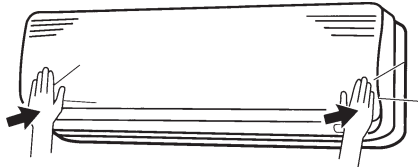

Load Batteries (R03/LR03 × 2)

- 1 Press and slide the battery compartment lid on the reverse side to open it.
Slide in the direction of the arrow while pressing the ▼ mark.
- 2 Insert batteries.
Be sure to align the battery polarities (⊕/⊖) correctly.
- 3 Close the battery compartment lid.

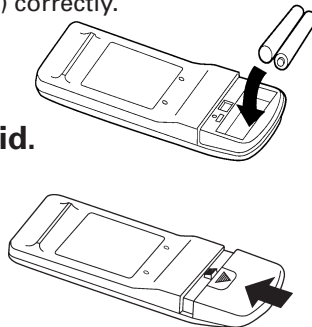

⚠ CAUTION!

- Take care to prevent infants from accidentally swallowing batteries.
- When not using the remote control unit for an extended period, remove the batteries to avoid possible leakage and damage to the unit.
- If leaking battery fluid comes in contact with your skin, eyes, or mouth, immediately wash with copious amounts of water, and consult your physician.
- Dead batteries should be removed quickly and disposed of properly, either by placing in a public battery collection receptacle, or by returning to appropriate authority.
- Do not attempt to recharge dry batteries.

Never mix new and used batteries, or batteries of different types. Batteries should last about one year under normal use. If the remote control unit's operating range becomes appreciably reduced, replace the batteries and press the ACL button with the tip of a ballpoint pen or other small object.

Set the Current time

- 1 Press the TIME ADJUST button (Fig. 6 ㉔).**
Use the tip of a ball-point pen or other small object to press the button.
- 2 Use the (+/-) SET TIME buttons (Fig. 5 ㉑) to adjust the clock to the current time.**
+ button: Press to advance the time.
- button: Press to reverse the time.
(Each time the buttons are pressed, the time will be advanced/reversed in one-minute increments; hold the buttons depressed to change the time quickly in ten-minute increments.)
- 3 Press the TIME ADJUST button again.**
This completes the time setting and starts the clock.

To Use the Remote Control Unit

- The remote control unit must be pointed at signal receiver (Fig. 1 ㉑) to operate correctly.
- Operating range: About 7 meters.
- When a signal is properly received by the air conditioner, a beeping sound will be heard.
- If no beep is heard, press the remote control unit button again.

Remote Control Unit Holder

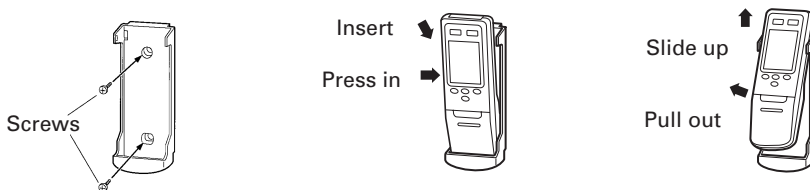

- ① **Mount the Holder.**
- ② **Set the Remote Control Unit.**
- ③ **To remove the Remote Control Unit (when use at hand).**

- Signals will not be transmitted properly if a wall, curtain, or other object is between the air conditioner and the remote control unit.
- The air conditioner may fail to operate properly if strong direct light is allowed to strike the signal receiver. Use a curtain to shade strong sunlight from windows, and place strong lamps at a distance away from the signal receiver.
- If another electric appliance is operated by the remote control unit move the appliance away or consult with authorized service personnel.
- Do not place the remote control unit in locations where it may be subjected to heat from direct sunlight or from heating apparatus.
- Do not subject the remote control unit to strong impacts, and do not allow water or other liquids to splash on it.
- When the remote control unit is used in rooms furnished with instant-lighting type fluorescent lamps, the air conditioner may fail to receive control signals correctly. Consult with authorized service personnel when purchasing a new fluorescent lamp.

OPERATION

Instructions relating to heating (*) are applicable only to "HEAT & COOL MODEL" (Reverse Cycle).

To Select AUTOMATIC Operation

- 1 Press the START/STOP button (Fig. 5 ㉓).**
The air conditioner will start operation.
- 2 Press the MASTER CONTROL button to select AUTO (Fig. 5 ㉔).**
The operating mode "AUTO" will appear alone in the display. The transmit indicator will flash to indicate the command has been sent, and about three seconds later the entire display panel will reappear.

About Automatic Operation [COOLING MODEL]

- Depending on the room temperature at the time operation begins, the operating mode will be switched automatically as shown in the accompanying table. Also, depending on the operating mode, the room temperature setting will cause the "normal" temperature to be set as shown.
- Once the operating mode has been set, the mode will not change even if the room temperature changes.
- In the dry mode, the fan will operate slowly to prevent room humidity from rising, and the room fan may stop.

Room Temperature	Operating Mode	Temperature Setting ("normal" setting)
30 °C or more	Cooling	27 °C
27 °C to 30 °C	Cooling	26 °C
25 °C to 27 °C	Dry	24 °C
23 °C to 25 °C	Dry	22 °C
Less than 23 °C	Dry	20 °C

About AUTO CHANGEOVER Operation [REVERSE CYCLE MODEL]

- When AUTO CHANGEOVER operation is selected, the air conditioner selects the appropriate operation mode (Cooling or Heating) in response to your room's temperature.
- When AUTO CHANGEOVER operation first selected, the fan will operate at very low speed for about one minute, during which time the unit detects the room conditions and selects the proper operating mode.
- When the air conditioner has adjusted your room's temperature to near the thermostat setting, it will begin monitor operation. In the monitor operation mode, the fan will

operate at low speed. If the room temperature subsequently changes, the air conditioner will once again select the appropriate operation (Heating, Cooling) to adjust the temperature to the value set in the thermostat. (The monitor operation range is ± 2 °C relative to the thermostat setting.)

- If the mode automatically selected by the unit is not what you wish, see page 7 and select one of the mode operation (HEAT, COOL, DRY, FAN).

To Set the Thermostat

Press the TEMPERATURE set button.

● COOLING MODEL

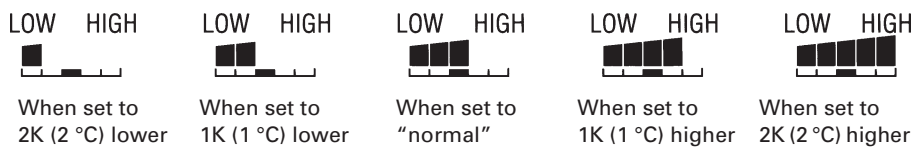

● REVERSE CYCLE MODEL

The temperature can be set to 27°, 25°, 23°, 21° or 19° (C).

About three seconds later, the entire display will reappear.

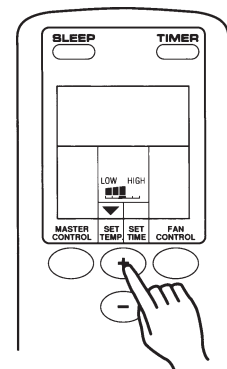

Example: When set to "normal"

The thermostat setting should be considered a standard value, and may differ somewhat from the actual room temperature.

To Change the Fan Speed

Press the FAN CONTROL button (Fig. 5 ②).

Each time the button is pressed, the fan speed changes in the following order:



About three seconds later, the entire display will reappear.

When the FAN CONTROL is set to AUTO:

COOL : Operation begins and as the room temperature approaches that of the thermostat setting, the fan speed switches to the low setting.

* **HEAT** : The fan operates at low speed at the beginning of operation or otherwise when the temperature of the emitted air is relatively low; the fan speed increases as the temperature of the emitted air rises.

As the difference between the thermostat setting and actual room temperature is reduced, the fan speed becomes slower.

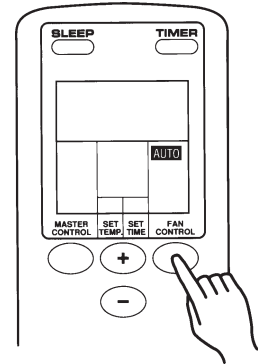

Example: When set to AUTO

To Stop Operation

Press the START/STOP button.

The OPERATION indicator lamp (red) (Fig. 3 ⑥) will light.

To Select Mode Operation

1 Press the START/STOP button (Fig. 5 ③).

The indoor unit's OPERATION indicator lamp (red) (Fig. 3 ⑥) will light. The air conditioner will start operating.

2 Press the MASTER CONTROL button (Fig. 5 ⑱) to select the desired mode.

Each time the button is pressed, the mode will change in the following order:



About three seconds later, the entire display will reappear.

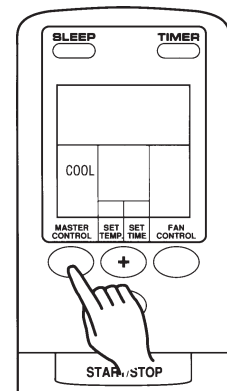

Example: When set to COOL

About Mode Operation

Cooling

- Use to cool your room.

Drying

- Use for gently cooling while dehumidifying your room.
- You cannot heat the room during Drying mode.
- During Drying mode, the unit will operate at low speed; in order to adjust room humidity, the indoor unit's fan may stop from time to time. Also, the fan may operate at very low speed when detecting room humidity.
- The fan speed cannot be changed manually when Drying mode has been selected.

Fan [COOLING MODEL]

- When using a space heater to heat the room, using the air conditioner's Fan setting will help prevent warm air from collecting near the ceiling, and thus assist in distributing warm air evenly throughout the room.
- Fan operation will begin automatically when the room temperature rises above the set temperature, and stop when the temperature falls below the set temperature.
- If the air emitted from the unit feels too cold, increase the temperature setting.

Fan [HEAT & COOL MODEL (Reverse Cycle)]

- Use to circulate air through your room without changing its temperature.

*Heating

- Use to warm your room.
- When Heating mode is selected, the air conditioner will operate at very low fan speed for about 3 to 5 minutes, after which it will switch to the selected fan setting. This period of time is provided to allow the indoor unit to warm up before begin full operation.
- When the room temperature is very low, frost may form on the outside unit, and its performance may be reduced. In order to remove such frost, the unit will automatically enter the defrost cycle from time to time. During defrost cycle, the red OPERATION indicator will flash, and the heat operation will be interrupted.

OPERATION

To Set the Thermostat

Press the **TEMPERATURE set button (Fig. 5 ⑱)**.

- ⊕ **button:** Press to increase the thermostat setting.
- ⊖ **button:** Press to lower the thermostat setting.

● **Thermostat setting range:**

COOLING MODEL	Cooling/Drying	18 to 30 °C
	Fan	17 to 30 °C
HEAT & COOL MODEL	Heating	16 to 30 °C
	Cooling/Drying	18 to 30 °C

About three seconds later, the entire display will reappear.

NOTE:

- The thermostat setting should be considered a standard value, and may differ somewhat from the actual room temperature.
- During Fan mode, set the unit to “--” for continuous fan operation regardless of room temperature. [COOLING MODEL ONLY]
- The thermostat cannot be used to set room temperature during the FAN mode (the temperature will not appear on the remote control unit’s display). [HEAT & COOL MODEL (Reverse Cycle) ONLY]

To Set the Fan Speed

Press the **FAN CONTROL button (Fig. 5 ⑳)**.

Each time the button is pressed, the fan speed changes in the following order:

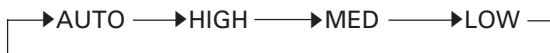

About three seconds later, the entire display will reappear.

When set to AUTO:

Cooling : Operation begins and as the room temperature approaches that of the thermostat setting, the fan speed switches to the low setting.

Fan: [COOLING MODEL]

Fan speed is selected automatically in accordance with nearby room temperature.

Fan: [HEAT & COOL MODEL (Reverse Cycle)]

Fan operation will alternate between low speed and off.

- * **Heating :** The fan operates at low speed at the beginning of operation or otherwise when the temperature of the emitted air is relatively low; the fan speed increases as the temperature of the emitted air rises.

However, the fan will operate at very low speed when the air issued from the indoor unit is low (P. 7).

To Stop Operation

Press the **START/STOP button**.

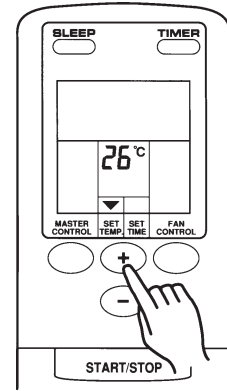

Example: When set to 26 °C

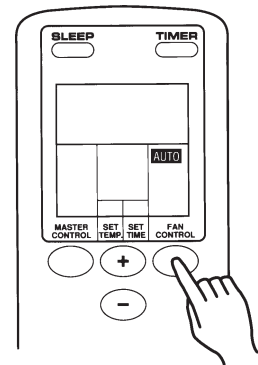

Example: When set to AUTO

* During Heating mode:

Set the thermostat to a temperature setting that is higher than the current room temperature. The Heating mode will not operate if the thermostat is set lower than the actual room temperature.

During Cooling/Dry mode:

Set the thermostat to a temperature setting that is lower than the current room temperature. The Cooling and Dry modes will not operate if the thermostat is set higher than the actual room temperature (in Cooling mode, the fan alone will operate).

During Fan mode:

You can not use the unit to heat and cool your room.

AIR DIRECTION ADJUSTMENT

Instructions relating to heating (*) are applicable only to "HEAT & COOL MODEL" (Reverse Cycle).

- Use the remote control unit's AIR FLOW DIRECTION button to adjust the up-down direction of airflow. (Left-right air direction is changed by manually moving the air louvers.)
- Begin unit operation and confirm that the airflow-direction louvers are stopped before setting the airflow-direction.

WARNING!

- Do not put fingers or other objects into the air louvers; an internal fan operates at high speed and could result in personal injury or damage.
- Do not operate the air conditioner with the airflow louvers blocked, since malfunction could result.

Automatic Airflow-Direction Adjustment

- The airflow-direction louvers is set automatically in accordance with the operating mode (cooling, etc.).

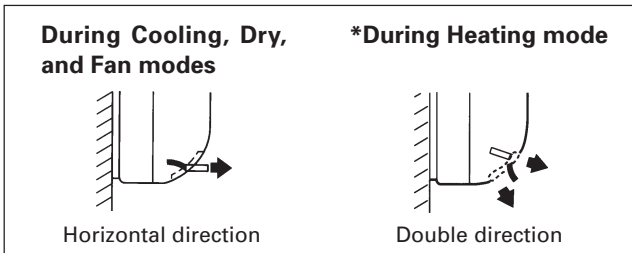

- During automatic operation mode (P. 6), the airflow-direction louvers will switch automatically in the following way:

Cooling: For four minutes after operation begins, the louver's direction is at a slight downward diagonal; thereafter, the direction switches to horizontal.

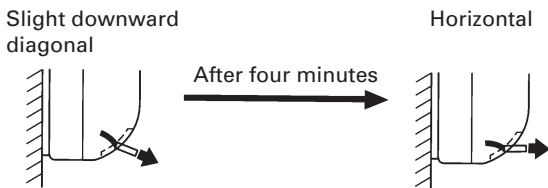

Dry, Monitor mode: Horizontal direction.

***Heating:** At the beginning of operation the louvers will direct the airflow downward to the floor area; as the room is gradually warmed, the flaps will change to permit double direction heating.

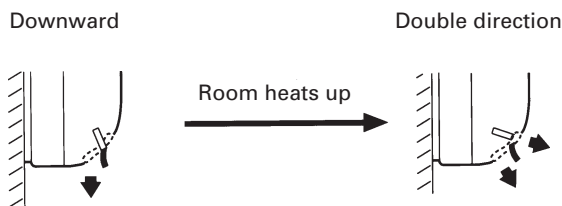

- If you wish to select a different airflow direction, you may use the remote control unit's airflow-direction button to choose a different setting.

- Always use the remote control unit's airflow-direction button to change the position of the up-down airflow-direction louvers. Do not attempt to set the louvers by hand, since it may result in improper operation. In this case, stop the air conditioner temporarily and then restart to return the louvers to proper operation.
- Never operate the air conditioner when the up-down airflow-direction louvers are closed.
- When the operating mode is changed, the up-down airflow-direction louvers will automatically change to their standard direction.
- In the cooling and drying modes, dew may condense around and drop from the air outlet ports when the louvers are set to the other cooling range. As a result, we recommend that this position be used only for brief periods.
- A certain time interval may be required after pressing the remote control unit's airflow-direction button until the louvers are set to the desired position. During that interval, the airflow-direction button will not respond, even if pressed.
- When the air conditioner operation is stopped, the up-down airflow direction louvers automatically move to close the outlet vent.

AIR DIRECTION ADJUSTMENT

Adjusting the Airflow-Direction

Press the AIR FLOW DIRECTION button.

- This control allows you to select a desired airflow direction.

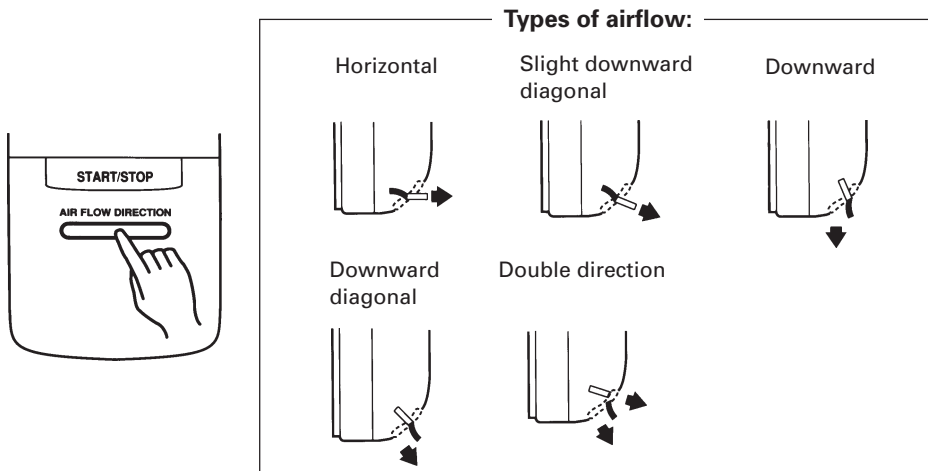

In order to heighten the efficiency of cooling and drying modes, the airflow-direction louvers should be set within the following ranges:

For Cooling: Horizontal, slight downward diagonal.

***For Heating:** Double direction, downward diagonal, downward.

Adjusting the Right-Left Direction

Adjust with the right-left louvers.

- Manually adjust the right-left louvers to the desired direction.

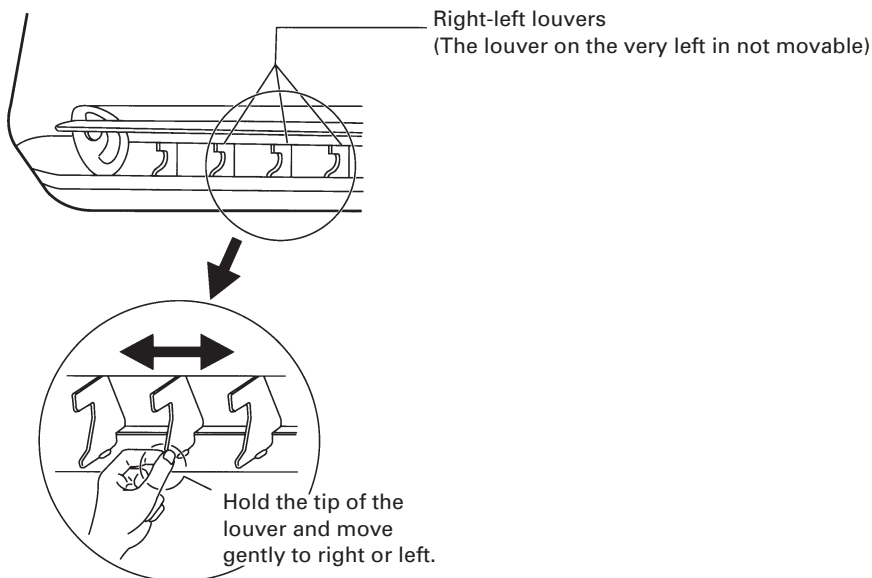

TIMER OPERATION

Before using the timer function, be sure that the remote control unit is set to the correct current time (P. 5).

To Use the ON timer or OFF timer

- 1 Press the START/STOP button (Fig. 5 ㉓)
(if the unit is already operating, proceed to step 2).**
The indoor unit's OPERATION indicator lamp (red) (Fig. 3 ㉖) will light.
- 2 Press the TIMER button (Fig. 5 ㉑) to select the OFF timer or ON timer operation.**
Each time the button is pressed the timer function changes in the following order:

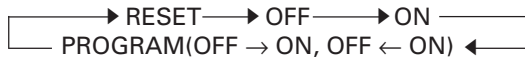

The indoor unit's TIMER indicator lamp (green) (Fig. 3 ㉗) will light.

- 3 Use the SET TIME buttons (Fig. 5 ㉙) to adjust the desired OFF time or ON time.**
Set the time while the time display is flashing (the flashing will continue for about five seconds).
 - + button:** Press to advance the time.
 - button:** Press to reverse the time.About three seconds later, the entire display will reappear.

To Use the PROGRAM timer

- 1 Press the START/STOP button (Fig. 5 ㉓)
(if the unit is already operating, proceed to step 2).**
The indoor unit's OPERATION indicator lamp (red) (Fig. 3 ㉖) will light.
- 2 Set the desired times for OFF timer and ON timer.**
See the section "To Use the ON timer or OFF timer" to set the desired mode and times.
About three seconds later, the entire display will reappear.
The indoor unit's TIMER indicator lamp (green) (Fig. 3 ㉗) will light.
- 3 Press the TIMER button (Fig. 5 ㉑) to select the PROGRAM timer operation (either OFF → ON or OFF ← ON will display).**
The display will alternately show "OFF timer" and "ON timer", then change to show the time setting for the operation to occur first.
 - The PROGRAM timer will begin operation. (If the ON timer has been selected to operate first, the unit will stop operating at this point.)About three seconds later, the entire display will reappear.

About the PROGRAM timer

- The PROGRAM timer allows you to integrate OFF timer and ON timer operations in a single sequence. The sequence can involve one transition from OFF timer to ON timer, or from ON timer to OFF timer, within a twenty-four hour period.
- The first timer function to operate will be the one set nearest to the current time. The order of operation is indicated by the arrow in the remote control unit's display (OFF → ON, or OFF ← ON).
- One example of PROGRAM timer use might be to have the air conditioner automatically stop (OFF timer) after you go to sleep, then start (ON timer) automatically in the morning before you rise.

To Cancel the Timer

Use the TIMER button to select "TIMER RESET".
The air conditioner will return to normal operation.

To Change the Timer Settings

Perform steps 2 and 3.

To Stop Air Conditioner Operation while the Timer is Operating

Press the START/STOP button.

To Change Operating Conditions

If you wish to change operating conditions (Mode, Fan Speed, Thermostat Setting, Air flow direction), after making the timer setting wait until the entire display reappears, then press the appropriate buttons to change the operating condition desired.

To Cancel the Timer

Use the TIMER button to select "TIMER RESET".
The air conditioner will return to normal operation.

To Change the Timer Settings

1. Follow the instructions given in the section "To Use the ON Timer or OFF Timer" to select the timer setting you wish to change.
2. Press the TIMER button to select either OFF → ON or OFF ← ON.

To Stop Air Conditioner Operation while the Timer is Operating

Press the START/STOP button.

To Change Operating Conditions

If you wish to change operating conditions (Mode, Fan Speed, Thermostat Setting, Air flow direction), after making the timer setting wait until the entire display reappears, then press the appropriate buttons to change the operating condition desired.

SLEEP TIMER OPERATION

Instructions relating to heating (*) are applicable only to "HEAT & COOL MODEL" (Reverse Cycle).

Unlike other timer functions, the SLEEP timer is used to set the length of time until air conditioner operation is stopped (for example, 2:00 hours).

To Use the SLEEP timer

While the air conditioner is operating or stopped, press the **SLEEP button (Fig. 5 ⑰)**.

Both the indoor unit's OPERATION indicator lamp (red) (Fig. 3 ⑥) and the TIMER indicator lamp (green) (Fig. 3 ⑦) will light.

To Change the Timer Settings

Press the **SLEEP button (Fig. 5 ⑰)** once again and set the time using the **SET TIME buttons (Fig. 5 ⑲)**.

Set the time while the Timer Mode Display is flashing (the flashing will continue for about five seconds).

- ⊕ **button:** Press to advance the time.
- ⊖ **button:** Press to reverse the time.

About three seconds later, the entire display will reappear.

About the SLEEP timer

To prevent excessive warming or cooling during sleep, the SLEEP timer function automatically modifies the thermostat setting in accordance with the time setting. When the set time has elapsed, the air conditioner completely stops.

During Heating operation (HEAT & COOL MODEL (Reverse cycle) only):

When the SLEEP timer is set, the thermostat setting is automatically lowered 1 °C every thirty minutes. When the thermostat has been lowered a total of 4 °C, the thermostat setting at that time is maintained until the set time has elapsed, at which time the air conditioner automatically turns off.

SLEEP timer setting

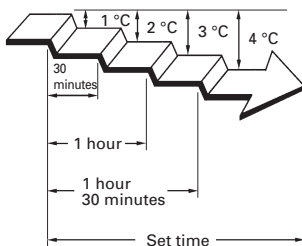

During Cooling/Dry operation:

When the SLEEP timer is set, the thermostat setting is automatically raised 1 °C every sixty minutes. When the thermostat has been raised a total of 2 °C, the thermostat setting at that time is maintained until the set time has elapsed, at which time the air conditioner automatically turns off.

SLEEP timer setting

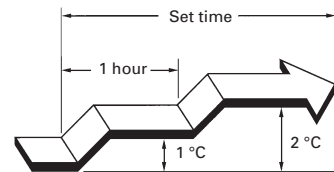

To Cancel the Timer:

Use the **TIMER button** to select "TIMER RESET".

The air conditioner will return to normal operation.

To Stop the Air Conditioner During Timer Operation:

Press the **START/STOP button**.

CARE AND MAINTENANCE



CAUTION!

- Before cleaning the unit, be sure to stop the unit and disconnect the power supply.
- Disconnect the power plug.
- Turn off the electrical breaker.
- A fan operates at high speed inside the unit, and personal injury could result.

When cleaning the air conditioner, disconnect the power plug or turn off the electrical breaker.

Never use water that is hotter than 40 °C. The body may warp or change colour.

The unit can be damaged by gasoline, benzine, thinners, insecticides and other chemical agents.

Do not use inflammable sprays such as lacquer or hair spray near the air conditioner.

Cleaning the Indoor Unit

Clean the indoor unit by wiping with a cloth dipped in cool or warm water, then wipe with another soft, clean, dry cloth.

When Not Using the Unit for Extended Periods (One Month or More)

Operate the unit on fan mode for about one-half day on a day with clear weather, to assure that the internal parts are dry (☞ P. 7).

Check the Power Cord

Check the power cord occasionally to confirm that it is not damaged by cuts or abrasions. If you discover damage to the cord, consult authorized service personnel.

Inspections and Repairs

Depending on the conditions of use, the internal parts of an air conditioner will become dirty after about two or three seasons of use, and performance may be affected. For this reason, regular professional maintenance is recommended. Consult authorized service personnel.



CAUTION!

When not using the unit for extended periods, disconnect the power plug for safety.

- When a plug is left connected, dust may collect on the blades, leading to smoke and fire hazard.

CARE AND MAINTENANCE

Cleaning the Intake Grille

1. Removing the Intake Grille

- ① Press in both lower edges of the intake grille until you hear a clicking sound and open the grille.
- ② Open the grille farther.



- ③ Lift up the intake grille until it can be removed (the grille cannot be removed unless it is raised sufficiently).

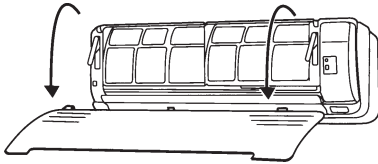

2. Cleaning the Intake Grille

Use a vacuum cleaner to remove dust accumulations, then wipe the grille with a clean cloth dipped in warm water; wipe with a clean dry cloth to remove any water.

3. Installing the Intake Grille

- ① Hold the intake grille horizontally and fasten the two hooks on the front panel.

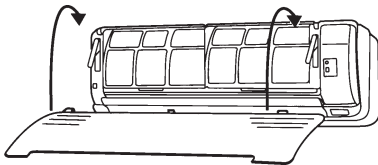

- ② Press the both lower sides of the intake grille until you hear a clicking sound and the grille locks into place.

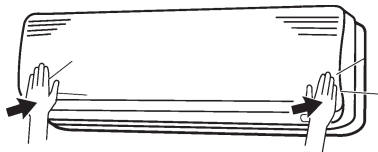

Cleaning the Air Filter

If dirt is allowed to collect in the air filter, the airflow will be reduced, leading to reduced performance, and increased operating noise. Be sure to clean the filters at the beginning of the operating season, and about every two weeks during periods of frequent operation.

1. Removing the Air Filter

- ① Remove the intake grille.
- ② Hold on to the air filter handles and pull up slightly to release the two lower hooks. Then pull the air filter down and out.

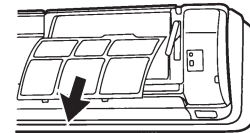
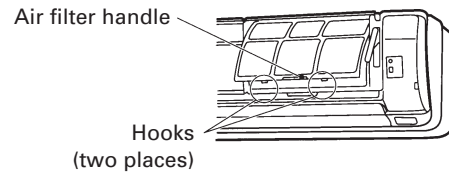

2. Cleaning the Air Filter

Either use a vacuum cleaner to remove accumulated dust, or wash in a neutral detergent solution. When washing the filter, allow it to dry well in a shaded location before reinstalling it in the air conditioner.

3. Installing the Air Filter

- ① Align the air filter with the ditch of the panel and press in until it stops.
- ② Insert the air filter's two hooks in the holes in the front panel and press in.
- ③ Close the intake grille.

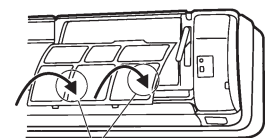
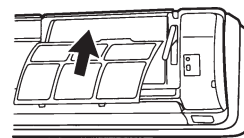

Hooks (two places)

TROUBLESHOOTING

Instructions relating to heating (*) are applicable only to "HEAT & COOL MODEL" (Reverse Cycle).



WARNING!

In the event of a malfunction (burning smell, etc.), immediately stop operation, turn off the electrical breaker or disconnect the power supply plug, and consult authorized service personnel. Merely turning off the unit's power switch will not completely disconnect the unit from the power source. Always be sure to turn off the electrical breaker or disconnect the power supply plug to ensure that power is completely off.

Before requesting service, perform the following checks:

	Symptom	Problem	See Page
NORMAL FUNCTION	Doesn't operate immediately:	<ul style="list-style-type: none"> ● If the unit is stopped and then immediately started again, the compressor will not operate for about 3 minutes, in order to prevent fuse blowouts. ● Whenever the electrical breaker is turned off then on again or the power supply plug is disconnected and then reconnected, the protection circuit will operate for about 3 minutes, preventing unit operation during that period. 	—
	Noise is heard:	<ul style="list-style-type: none"> ● During operation and immediately after stopping the unit, the sound of water flowing in the air conditioner's piping may be heard. Also, noise may be particularly noticeable for about 2 to 3 minutes after starting operation (sound of coolant flowing). ● During operation, a slight squeaking sound may be heard. This is the result of minute expansion and contraction of the front cover due to temperature changes. 	—
		*● During Heating operation, a sizzling sound may be heard occasional. This sound is produced by the Automatic Defrosting operation.	17
	Smells:	<ul style="list-style-type: none"> ● Some smell may be emitted from the indoor unit. This smell is the result of room smells (furniture, tobacco, etc.) which have been taken into the air conditioner. 	—
	Mist or steam are emitted:	<ul style="list-style-type: none"> ● During Cooling or Dry operation, a thin mist may be seen emitted from the indoor unit. This results from the sudden Cooling of room air by the air emitted from the air conditioner, resulting in condensation and misting. 	—
		*● During Heating operation, the outdoor unit's fan may stop, and steam may be seen rising from the unit. This is due to Automatic Defrosting operation.	17
	Airflow is weak or stops:	*● When Heating operation is started, fan speed is temporarily very low, to allow internal parts to warm up.	—
		*● During Heating operation, if the room temperature rises above the thermostat setting, the outdoor unit will stop, and the indoor unit will operate at very low fan speed. If you wish to warm the room further, set the thermostat for a higher setting.	
		*● During Heating operation, the unit will temporarily stop operation (between 6 and 12 minutes) as the Automatic Defrosting mode operates. During Automatic Defrosting operation, the OPERATION indicator lamp will flash.	17
		● The fan may operate at very low speed during Dry operation or when the unit is monitoring the room's temperature.	8
● In the monitor AUTO operation, the fan will operate at very low speed.		7	
Water is produced from the outdoor unit:	*● During Heating operation, water may be produced from the outdoor unit due to Automatic Defrosting operation.	17	

TROUBLESHOOTING

Instructions relating to heating (*) are applicable only to "HEAT & COOL MODEL" (Reverse Cycle).



WARNING!

Consult authorized service personnel for any repairs.

	Symptom	Items to check	See Page
CHECK ONCE MORE	Doesn't operate at all:	<ul style="list-style-type: none"> ● Is the power plug disconnected from its outlet? ● Has there been a power failure? ● Has a fuse blown out, or a circuit breaker been tripped? 	—
		● Is the main power switch set to the OFF position?	4
		● Is the timer operating?	11 and 12
	Poor Cooling (or *Heating) performance:	<ul style="list-style-type: none"> ● Is the air filter dirty? ● Are the air conditioner's intake grille or outlet port blocked? ● Did you adjust the room temperature settings (thermostat) correctly? ● Is there a window or door open? ● In the case of Cooling operation, is a window allowing bright sunlight to enter? (Close the curtains.) ● In the case of Cooling operation, are there heating apparatus and computers inside the room, or are there too many people in the room? 	—
	The unit operates differently from the remote control unit's setting:	<ul style="list-style-type: none"> ● Are the remote control unit's batteries dead? ● Are the remote control unit's batteries loaded properly? 	4

If the problem persists after performing these checks, or if you notice burning smells, or the TIMER indicator lamp (Fig.3 ⑦) flashes, immediately stop operation, disconnect the power supply, and consult authorized service personnel.

OPERATION DETAILS

Instructions relating to heating (*) are applicable only to "HEAT & COOL MODEL" (Reverse Cycle).

Please read and understand the following details regarding this air conditioner.

Malfunction

Nearby lightning or use of a mobile radio (short wave, etc.) may result in malfunction. In this case, disconnect the power plug from its outlet and connect it again, then use the remote control unit to resume operation.

Auto Restart

- The air conditioner power has been interrupted by a power failure. The air conditioner will then restart automatically in its previous mode when the power is restored.
- Operated by settings before the power failure.
Then, the airflow-direction louvers will automatically change to their standard direction.
- If a power failure occurs during timer operation, the timer will be reset and the unit will begin (or stop) operation at the new time setting. In the event that this kind of timer fault occurs, the TIMER indicator will flash.

OPERATION DETAILS

Operation and Performance

*Heating Performance

- This air conditioner operates on the heat-pump principle, absorbing heat from outdoor air and transferring that heat indoors. As a result, the operating performance is reduced as outdoor air temperature drops. If you feel that insufficient heating performance is being produced, we recommend you use this air conditioner in conjunction with another kind of heating appliance.
- Heat-pump air conditioners heat your entire room by recirculating air throughout the room, with the result that some time may be required after first starting the air conditioner until the room is heated.

*When Indoor and Outdoor Temperatures are High

When both indoor and outdoor temperatures are high during use of the heating mode, the outdoor unit's fan may stop at times.

*Microcomputer-controlled Automatic Defrosting

When using the Heating mode under conditions of low outdoor air temperature high humidity, frost may form on the outdoor unit, resulting in reduced operating performance.

In order to prevent this kind of reduced performance, this unit is equipped with a Microcomputer-controlled Automatic Defrosting function. If frost forms, the air conditioner will temporarily stop, and the defrosting circuit will operate briefly (for about 6 to 12 minutes).

During Automatic Defrosting operation, the OPERATION indicator lamp (red) will flash.

*Low Ambient Cooling

When the outdoor temperature drops, the outdoor unit's fans may switch to Low Speed.

Temperature and Humidity Range

Permissible ranges of temperature and humidity are as follows:

COOLING/DRY MODE

	Outdoor Temperature	Indoor	
		Temperature	Humidity
COOLING MODEL	About 18 to 46 °C	About 18 to 32 °C	About 80 % or less If the unit is used for long periods under high-humidity conditions, condensation may form on the surface of the indoor unit, and drip onto the floor or other objects underneath.
HEAT & COOL MODEL (Reverse Cycle)			

*HEATING MODE

	Outdoor Temperature	Indoor Temperature
HEAT & COOL MODEL (Reverse Cycle)	About 0 to 21 °C	About 30 °C or less

- If the unit is used under higher temperature conditions than those noted here, the automatic protection circuit may operate, interrupting the operation. If the unit is used under lower temperature conditions than those noted here, the heat exchanger may freeze, causing water leakage or other malfunction.
- Do not use the air conditioner for any purpose other than room cooling, room heating, room drying or fan.

SPECIFICATIONS

MODEL			
INDOOR UNIT		ASY17AS	ASY17RS
OUTDOOR UNIT		AOY17AN	AOY17RN
TYPE		COOLING MODEL	HEAT & COOL MODEL (REVERSE CYCLE)
POWER		1~ 220-240 V 50 Hz	
COOLING			
CAPACITY	[kW]	4.75-4.90	4.70-4.80
POWER INPUT	[kW]	1.75-1.85	1.70-1.78
CURRENT	[A]	8.0-7.8	7.9-7.6
ENERGY EFFICIENCY RATIO	[kW/kW]	2.71-2.65	2.77-2.70
HEATING			
CAPACITY	[kW]	—	5.00-5.15
POWER INPUT	[kW]	—	1.85-1.92
CURRENT	[A]	—	8.6-8.2
ENERGY EFFICIENCY RATIO	[kW/kW]	—	2.70-2.68
MAX. PRESSURE		[kPa]	2,840
REFRIGERANT (R22)		[g]	1,300 1,500
DIMENSIONS & WEIGHT (NET)			
INDOOR UNIT			
HEIGHT	[mm]	285	
WIDTH	[mm]	900	
DEPTH	[mm]	172	
WEIGHT	[kg]	10	
OUTDOOR UNIT			
HEIGHT	[mm]	643	
WIDTH	[mm]	840	
DEPTH	[mm]	336	
WEIGHT	[kg]	55	59

- Acoustic Noise Information : The maximum sound pressure level is less than 70 dB (A) for both indoor unit and outdoor unit.
According to IEC 704-1 and ISO 3744.